

killerbody™

Liquid Masking Medium
For easy detail masking
NO.48066

Before beginning assembly, please read these instructions thoroughly!

● Symbols used throughout the instruction manual, comprise:



Cut off shaded portion.



5mm
Drill holes with
the specified diameter.



Pay close attention here!



Must be purchased
separately.



Assemble left and right sides
the same way.



This product can be used for any body shell, the body we used here just for a demonstration.

1 Preparation

Please prepare blow dryer, small brush, air spray gun, pen, utility knife and Killerbody's liquid Masking Medium.

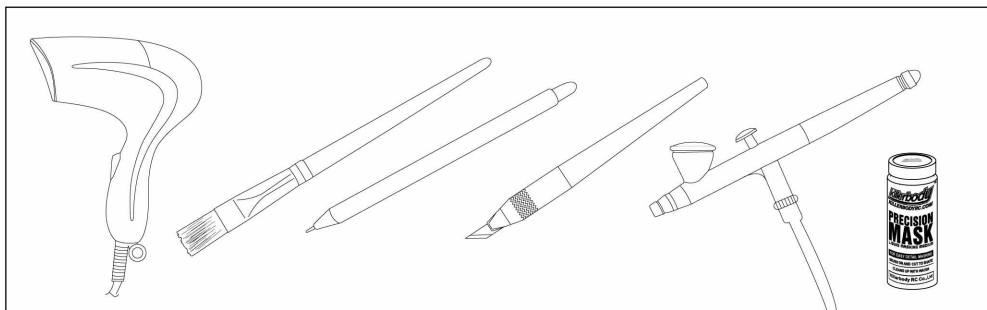

2 Clean

Clean the body carefully, then wipe off all the water stain.



3 Applying the liquid Masking Medium

Apply the liquid Masking Medium with a brush inside the body evenly.



Beware don't applying the Liquid Masking Medium too thick.

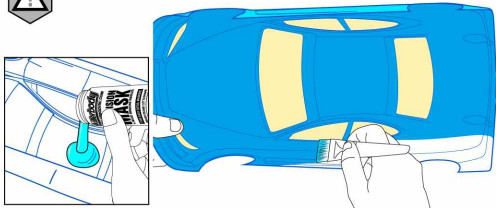

4 Blow dry

Blow dry the liquid Masking Medium using a blow dryer, the liquid Masking Medium will become a cover film after dried.



Please do not blow the wind under high temperature.

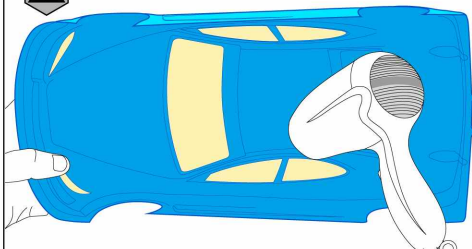

5 Drawing

Draw your desired pattern on the body outside protective film, like fire pattern in our illustration.

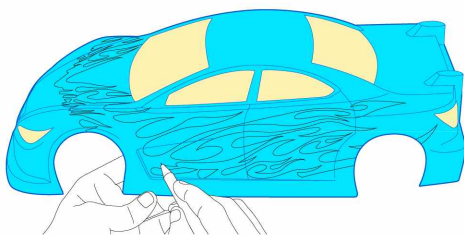

6 Cutting

Cut the liquid Masking Medium film using utility knife carefully along the outside draw line.



don't cut too deep, just cut through the liquid Masking Medium film.

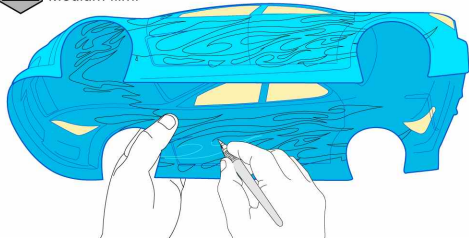

7 Remove the liquid Masking Medium film

After cutting done, peel out the liquid Masking Medium film where you want to paint.

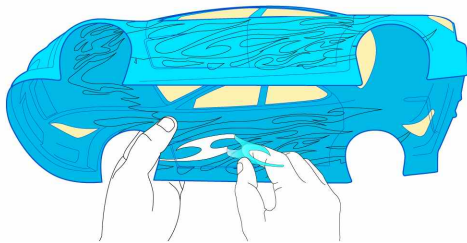

8 Spray-painting

Start spray painting

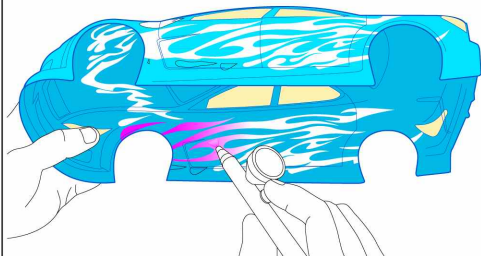

If you do spray-painting inside the body, normally you should start with darker colors then to lighter colors.

If you do spray-painting on the surface of the body, normally you should start with lighter colors then to darker colors.

You can make your own great work if you have enough patience!